

MARLBORO COUNTY INDUSTRIAL PARK BENNETTSVILLE, SOUTH CAROLINA

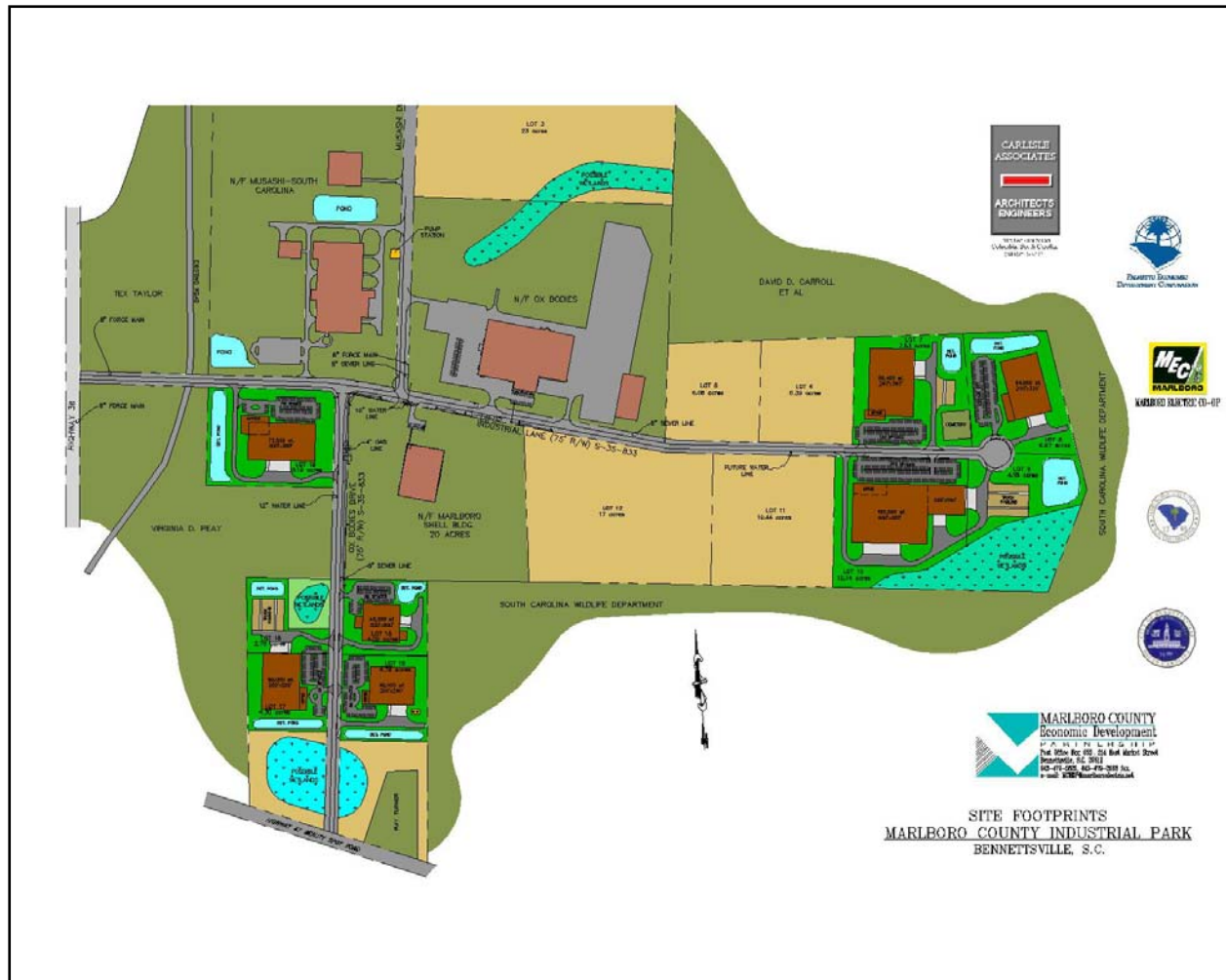

The Marlboro County Economic Development Office employed Carlisle Associates to complete prototypical layouts on available parcels in the Marlboro County Industrial Park located at the intersection of SC Highway 47 and SC Highway 38 near Bennettsville.

For this project, Carlisle Associates took the existing park master plan, updated it with recently constructed buildings, then completed seven possible layouts on strategic sites throughout the park. This enabled the Economic Development Office to show prospective tenants how a facility of the size they required could be adapted to each of the possible lots.

The final deliverables included the above color rendering of the park in electronic format, and seven enlarged layouts of the individual site plans for the prototype sites. All of these documents have proved helpful to the Economic Development Office in their marketing efforts.

Confidential